

Scaffalatura ad incastro a ripiani

Slot-in shelves system

Klemmregale mit Fachböden

Système de rayonnage emboîté à plans

Sistema para estanterías de encastre a repisas

È il sistema flessibile per la realizzazione di scaffali di media portata (fino a 6,5 t per spalla e 800 kg per ripiano*) per contenitori o unità di carico sfuse. Completabile con passerelle, può dar vita a strutture polifunzionali di cui è possibile anche lo sfruttamento intensivo con l'applicazione di sistemi automatici.

Medium-load capacity system for containers or goods in bulks (up to 6.5 ton each upright frame and 800 kg each shelf). It can be completed with catwalks to obtain multi-functional installations for intensive utilization with the application of automated systems.*

Dieses flexible System eignet sich für Regale mittlerer Tragfähigkeit für Container oder Einheiten mit loseem Inhalt (bis zu 6,5 Tonnen pro Schulter und 800 kg pro Boden). Es kann mit Stegen/Belegen erweitert werden und wird so zu einer multifunktionellen Struktur, die auch im Zusammenhang mit automatischen Anlagen intensiv genutzt werden kann.*

Est un système flexible pour réaliser des rayonnages de capacité moyenne, conteneurs ou marchandises en vrac (jusqu'à 6,5 tonnes par échelle ou 800 kg chaque plan). Muni de passerelles, ce système peut être la base pour des installations multifonction permettant une exploitation intensive et peut être si équipé d'outils automatiques.*

Es el sistema flexible para la realización de estantes de capacidad media, contenedores o unidades de cargo sueltas (hasta 6,5 ton por estribo y 800 kg para repisa). Completado con pasarelas puede dar vida a estructuras polifuncionales de las cuales es posible un aprovechamiento intensivo con la aplicación de sistemas automáticos.*

*carico uniformemente distribuito - *uniformly distributed load

*gleichmäßig verteilt - *charge uniformément distribuée -

*carga uniformemente distribuida



MATERIALE - Material

- Montanti e correnti: acciaio zincato Sendzimir S 350 GD UNI EN 10346
- Traversi/diagonali e tegole: acciaio zincato Sendzimir S 280 GD UNI EN 10346
- Basette: acciaio S235 JR UNI EN 10025 - zincatura elettrolitica

- Uprights, beams: Sendzimir galvanized steel S 350 GD UNI EN 10346
- Stringers/diagonals, tiles: Sendzimir galvanized steel S 280 GD UNI EN 10346
- Base plates: steel S235 JR UNI EN 10025 - electro-galvanized

- Pfosten, Balken aus Sendzimir verzinktem Stahl S350 GD UNI EN 10346
- Träger/Diagonal aus Sendzimir verzinktem Stahl S280 GD UNI EN 10346
- Fußplatte aus Stahl S235 JR UNI EN 10025 - galvanisch verzinkt

- Montant acier galvanisé Sendzimir S350 GD UNI EN 10346
- Travers/diagonal et tuiles: acier galvanisé Sendzimir S280 GD EN 10346
- Base: acier S235 JR UNI EN 10025 - zingage électrolytique

- Montante en acero galvanizado Sendzimir S350 GD UNI EN 10346
- Resorte/diagonal y tejas en acero galvanizado Sendzimir S280 GD UNI EN 10346
- Travesía en acero S235 JR UNI EN 10025 - galvanizado electrolítico

Norme di produzione

Manufacturing standards - Produktionsnormen - Normes de production - Normas de producción

- CNR UNI 10011/97 e CNR 10022/84
- Norme A.C.A.I./CISI
- D. Leg.vo 9 aprile 2008, n° 81

Marcegaglia, per la propria gamma produttiva, segue le Norme Europee:

- UNI EN 15512:2009 del 14/05/09
- UNI EN 15629:2009 del 19/03/09
- UNI EN 15635:2009 del 19/03/09

Soluzioni Light Bi-Bloc

Light Bi-Bloc combinations

Light Bi-Bloc Lösungen

Des solutions Light Bi-Bloc

Soluciones Light Bi Bloc

SCAFFALE CON RIPIANI A TEGOLE

Shelving with tile planks - Regal mit Ziegel-Einlegebrettern
Rayonnage à planches à tuiles - Estantería con estante a tejas

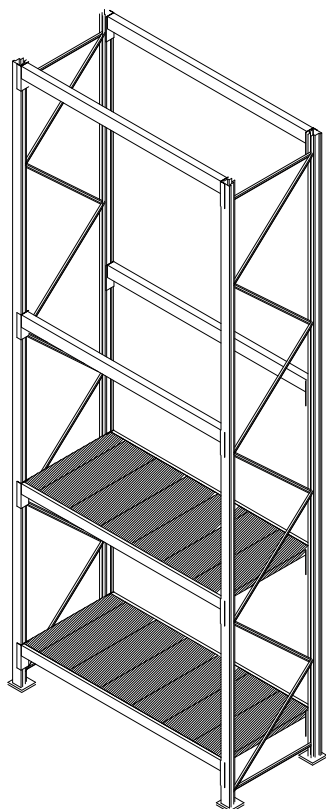

SCAFFALE CON PASSERELLA

Shelving with catwalk - Regal mit Stegen
Rayonnage à passerelle - Estantería con pasarela

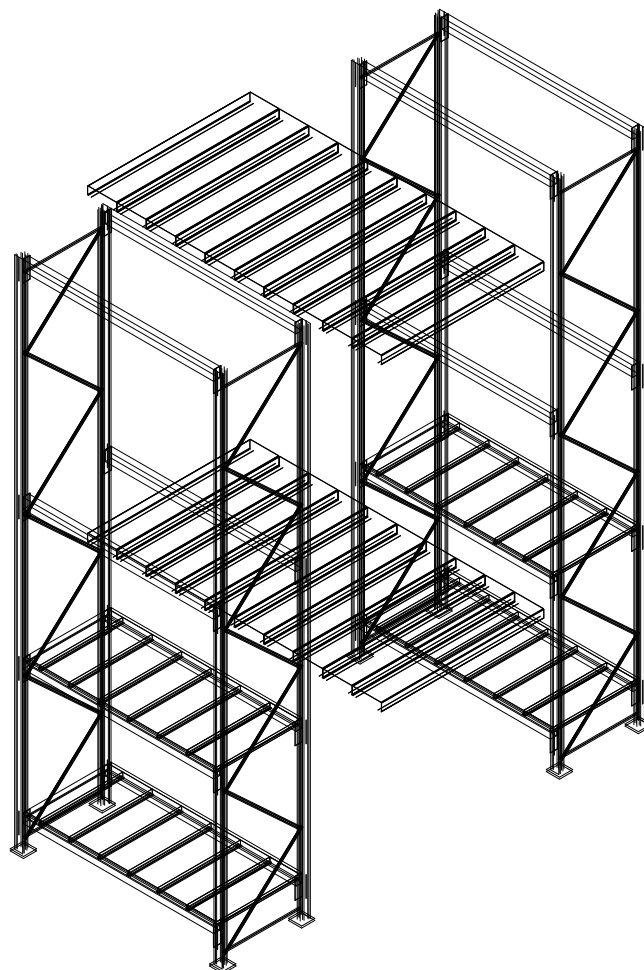

Attacco frontale passerella

Detail of catwalk front fixing

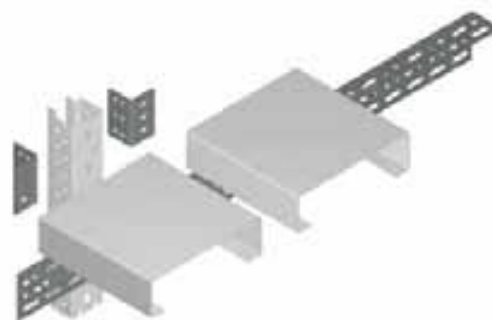
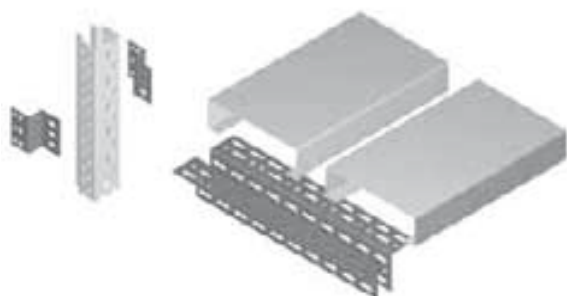

Schemi

Drawings
Schemata
Plans
Esquemas

CONFIGURAZIONE SPALLE (PROFONDITÀ: 400-500-600-800-1000-1200 mm)

Shoulder patterns (width: 400-500-600-800-1000-1200 mm)

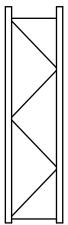

H 2200

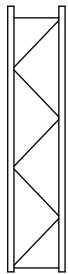

H 2700

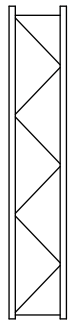

H 3200

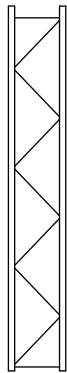

H 3700

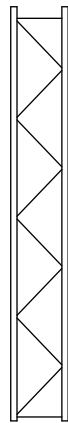

H 4200

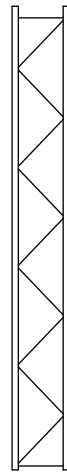

H 4700

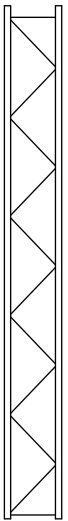

H 5200

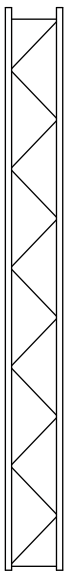

H 5700

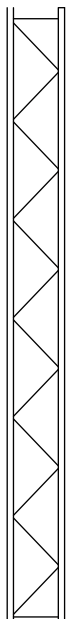

H 6200

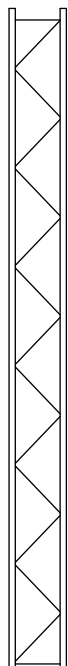

H 6700

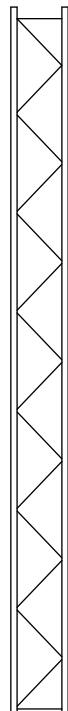

H 7200

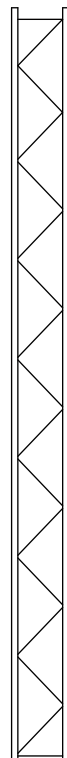

H 7700

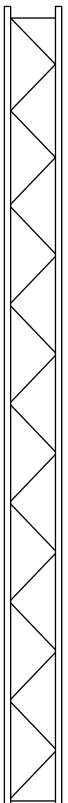

H 8200

Componenti Light Bi-Bloc

Light Bi-Bloc components
 Light Bi-Bloc Bestandteile
 Composants Light Bi-Bloc
 Componentes Light Bi-Bloc

| SPALLE - Abutments | | | | | | |
|--|------------------------|--------|-----------|----------------------------|--------|-----------|
| Larghezza spalle (mm) Abutments width | Traversi - Cross beams | | | Diagonali - Diagonal beams | | |
| | a (mm) | A (mm) | Peso (kg) | a (mm) | A (mm) | Peso (kg) |
| 400 | 303 | 333 | 0,19 | 585 | 615 | 0,34 |
| 500 | 403 | 403 | 0,24 | 642 | 672 | 0,38 |
| 600 | 503 | 533 | 0,30 | 709 | 739 | 0,41 |
| 800 | 703 | 733 | 0,41 | 863 | 893 | 0,50 |
| 1000 | 903 | 933 | 0,52 | 1032 | 1062 | 0,59 |
| 1200 | 1103 | 1133 | 0,63 | 1211 | 1241 | 0,69 |

| PORTATA AMMISSIBILE SPALLE - Permitted abutments capacity | | |
|---|--------------|--------------|
| Interasse correnti (mm) Beams inter-axis | S55/45B (kg) | S55/55B (kg) |
| 600 | 4600 | 6500 |
| 900 | 4200 | 5800 |
| 1200 | 3700 | 4700 |
| 1500 | 3200 | 4100 |
| 1800 | 2900 | 3900 |
| 2100 | 2400 | 3200 |

Nota:

1. Il carico ammissibile s'intende equamente ripartito tra i due montanti delle spalle. Vanno esaminate attentamente le situazioni con carichi sbilanciati nel senso della profondità delle spalle.
2. H = altezza del primo corrente dal pavimento. Nel caso che il passo dei correnti successivi in altezza sia superiore, si verifichi tale tratto di spalla assumendo come "H" tale passo.
3. Per ogni campata ci devono essere almeno 2 coppie di correnti in altezza in modo da assicurare la stabilità longitudinale (nel caso di spalle giuntate mettere 3 coppie di correnti in altezza).
4. Per la determinazione delle tipologie del profilo si escluderanno i carichi gravanti sull'eventuale coppia di correnti a terra.

Notice:

1. The permitted load is understood as uniformly distributed over the two abutment uprights. Possible unbalanced loads over the tunnel length must be carefully studied in advance.
2. Being 'H' the height of the first beam from the floor, assume H as pitch distance between the next beams in case it might be higher.
3. In order to ensure longitudinal stability, at least 2 pairs of beams must be present in vertical direction (3 pairs in case of jointed shoulders).
4. Exclude the load over the beams fixed into the round when determining the type of profiles.



MONTANTE S55/45B

Upright S55/45B

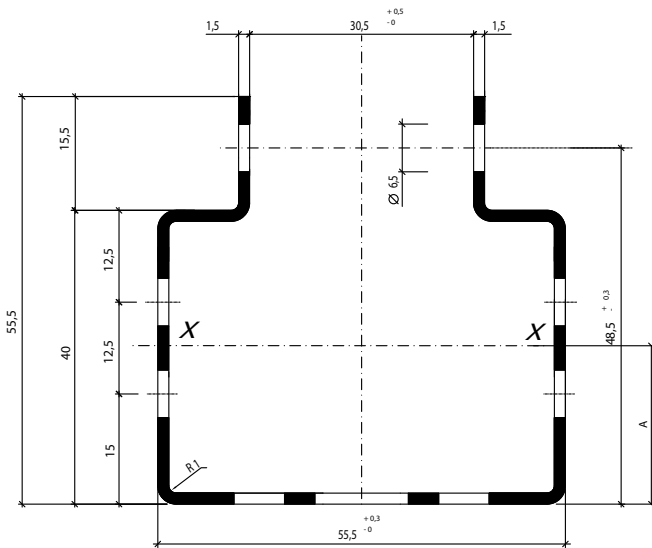

MONTANTE S55/55B

Upright S55/55B

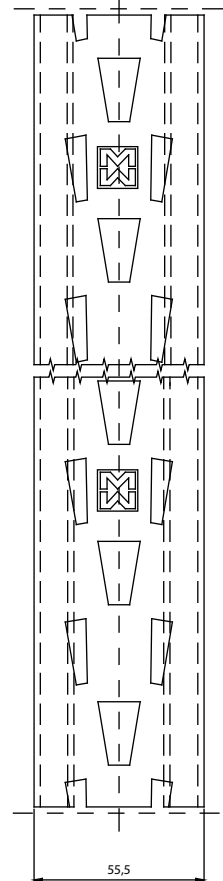
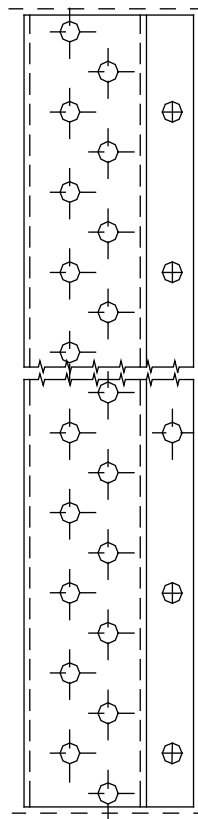
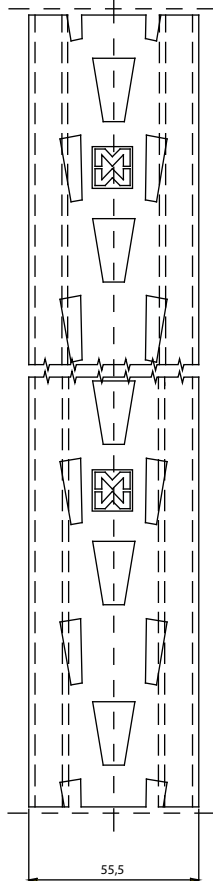
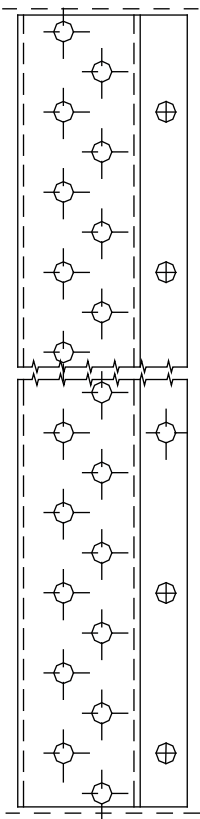
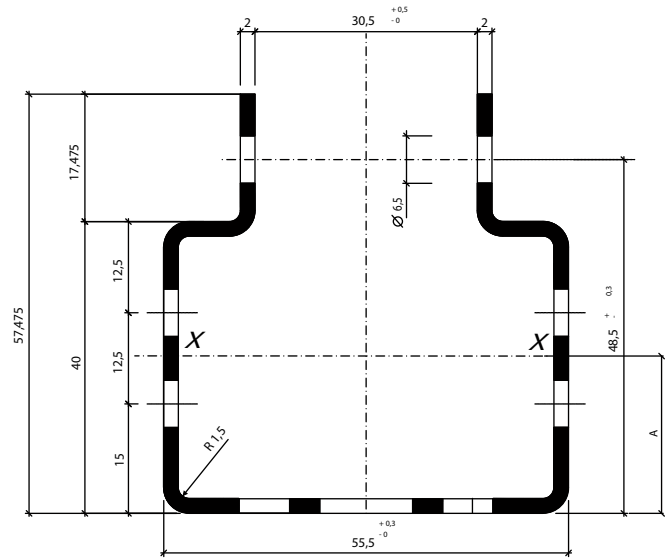

H = 2200 - 2700 - 3200 - 3700 - 4200 - 4700 - 5200 - 5700 - 6200 - 6700 - 7200 - 7700 - 8200

TRAVERSINO E DIAGONALE S55/45B e S55/55B

Cross and diagonal beam S55/45B and S55/55B

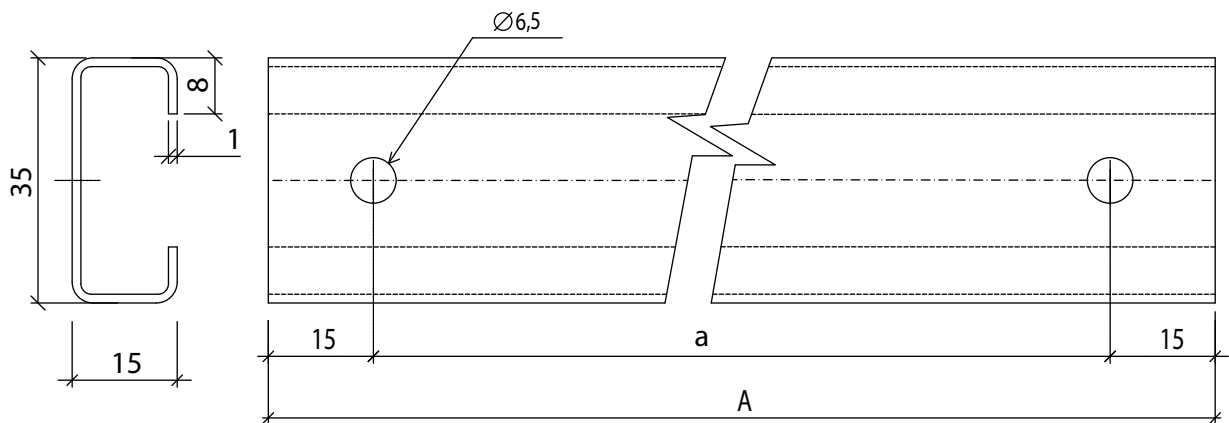

DISPOSIZIONE TRAVERSINI E DIAGONALI

Scheme of cross and diagonal beams

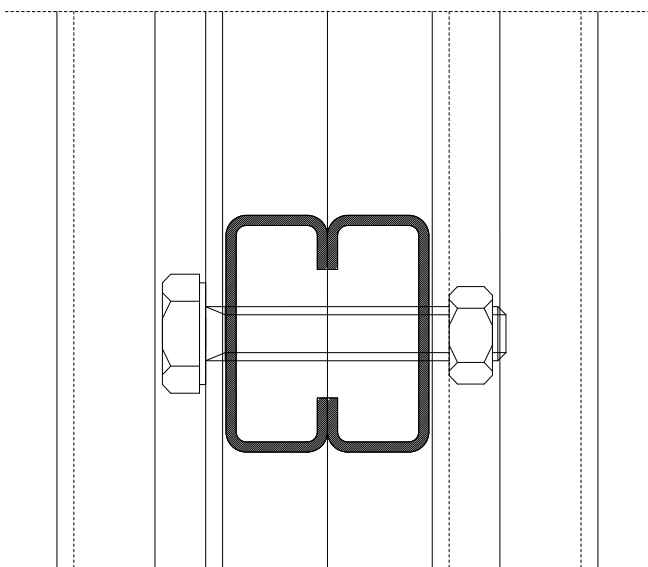

COMPENSO DI ESTREMITÀ TRAVERSINI

Cross beam terminal spacer

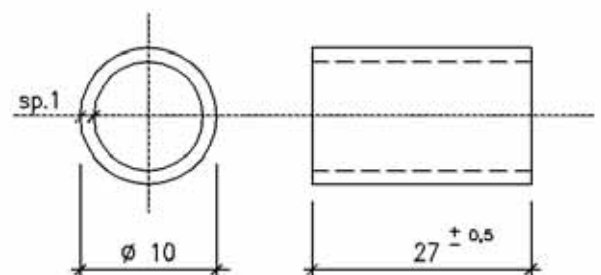

BASSETTA SEMPLICE

Simple base plate

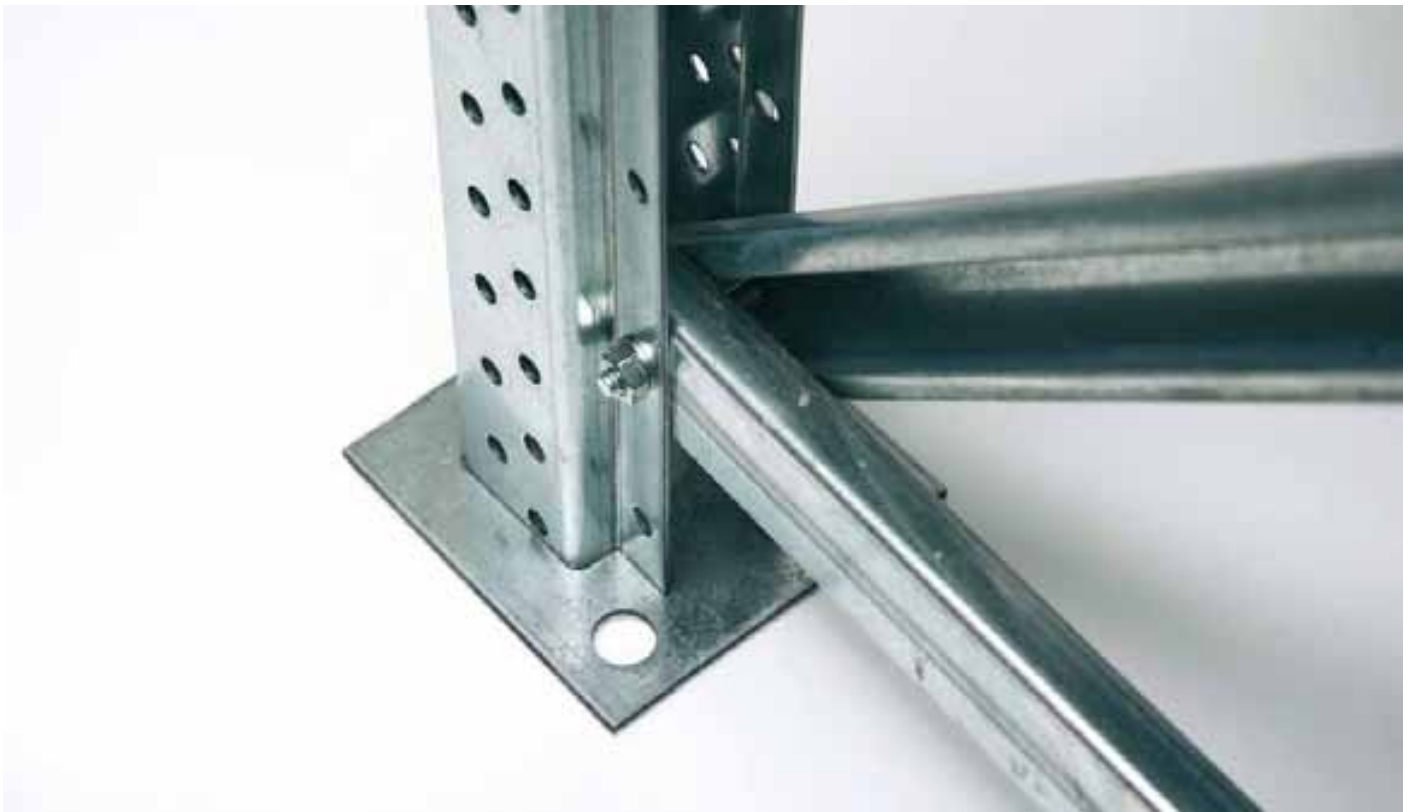
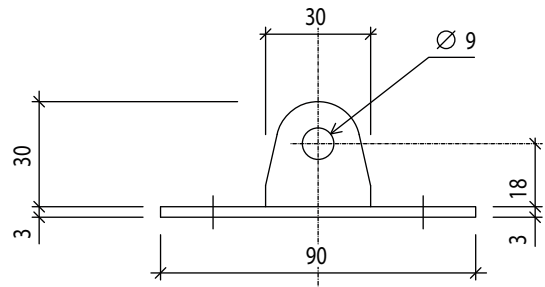
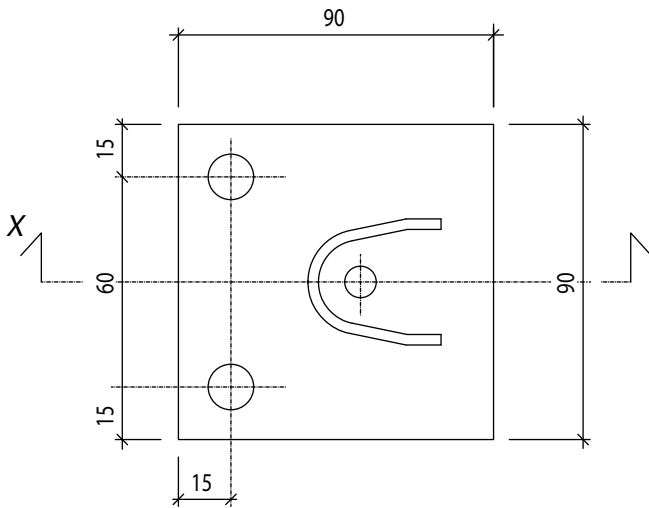

BASETTA PER IMPIANTI

Base plate for installations

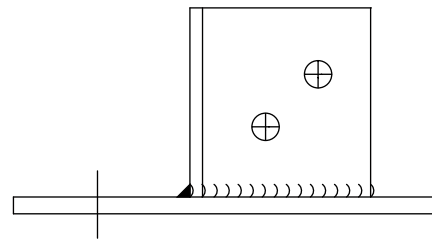
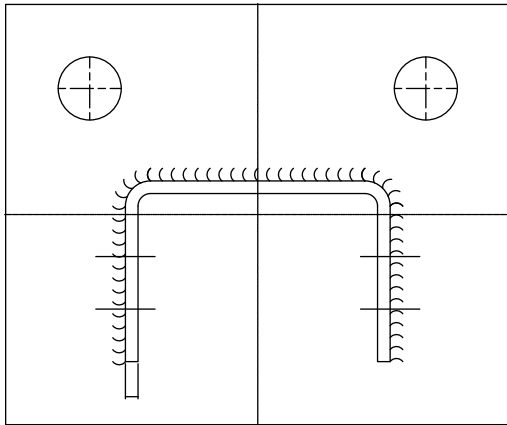

ANCORAGGIO A PARETE

Wall anchor

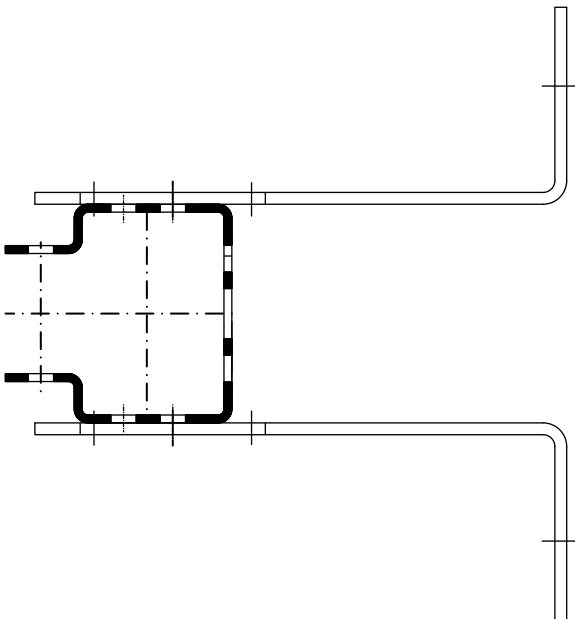

ARRESTO CORRENTE

Beam stopper

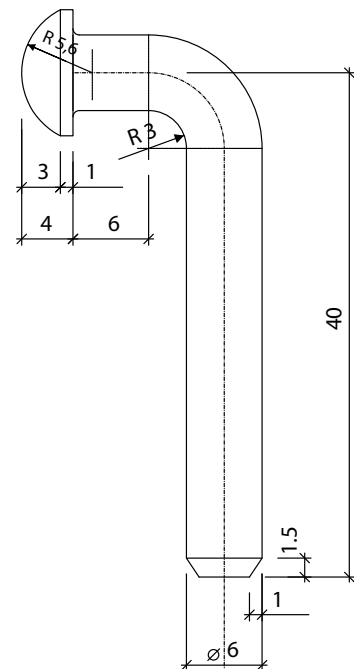

CORRENTE LIGHT BI-BLOC Sp. 1,5 mm

Beam thickness 1.5 mm

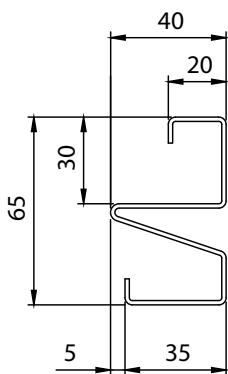
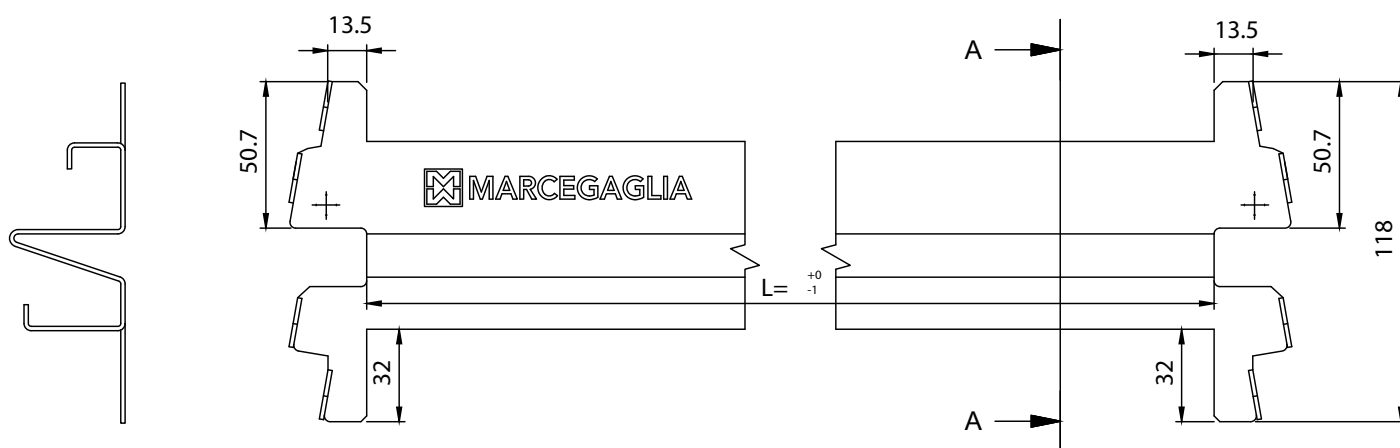

CORRENTI STANDARD PER TEGOLE 100 E 200 LBB

Standard beams for tiles 100 and 200 LBB

| Lunghezza nominale Nominal length | Q portata kg Q load capacity kg |
|--------------------------------------|------------------------------------|
| 1200 | 800 |
| 1500 | 770 |
| 1800 | 600 |
| 2000 | 480 |
| 2400 | 320 |

CORRENTI STANDARD PER PANNELLI LBB 100-200-300

Standard beams for panels LBB 100-200-300

| Codice Code | Lunghezza nominale Nominal length | L=mm | Q portata kg Q load capacity kg | Peso kg Weigh kg |
|----------------|--------------------------------------|------|------------------------------------|---------------------|
| 3681900915 | 1200 | 1205 | 800 | 2,72 |
| 3681901515 | 1500 | 1505 | 770 | 3,39 |
| 3681901715 | 1600 | 1605 | 740 | 3,61 |
| 3681902125 | 1800 | 1810 | 600 | 4,06 |
| 3681902525 | 2000 | 2010 | 480 | 4,50 |
| 3681902725 | 2100 | 2110 | 430 | 4,72 |
| 3681903325 | 2400 | 2410 | 320 | 5,39 |



Ripiani a tegole

Tile planks
Ziegel-Einlegebretter
Planches à tuiles
Estantes metálicos

TEGOLE LIGHT BI-BLOC

Tiles

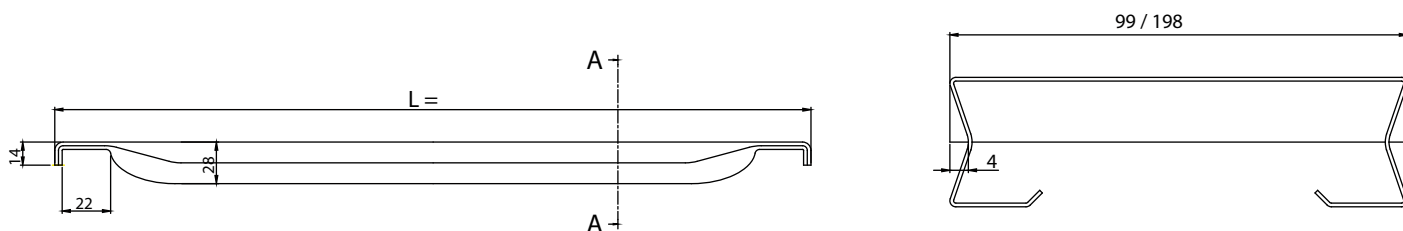

TEGOLE LIGHT BI-BLOC Sp. 0,6 - Tiles light Bi-Bloc thickness 0,6

| Tegole 200 LBB Tiles 200 LBB | Portata kg. C.u.d. load capacity kg. C.u.d. |
|---------------------------------|--|
| 200 x 400 | 130 |
| 200 x 500 | 115 |
| 200 x 600 | 100 |
| 200 x 800 | 80 |
| 200 x 1000 | 60 |
| 200 x 1200 | 50 |

TEGOLE LIGHT BI-BLOC Sp. 0,6 - Tiles light Bi-Bloc thickness 0,6

| Tegole 100 LBB Tiles 100 LBB | Portata kg. C.u.d. load capacity kg. C.u.d. |
|---------------------------------|--|
| 100 x 400 | 130 |
| 100 x 500 | 115 |
| 100 x 600 | 100 |
| 100 x 800 | 80 |
| 100 x 1000 | 60 |
| 100 x 1200 | 50 |



PORTATA PIANI DI CARICO

Shelves load capacity

PORTATE PIANI LIGHT BI-BLOC CON TEGOLE 200 SPESSORE 0,6 - Load capacity Light Bi-Bloc shelves with tiles 200, thickness 0,6

| L. nom (mm) Nominal length (mm) | L. reale (mm) Length (mm) | Nr. Tegole N. of tiles | | Portata correnti Beams load capacity | Profondità spalla (mm) Upright frame depth (mm) | | | | | |
|--|---------------------------------|---------------------------|----------|---|--|------------|------------|------------|------------|------------|
| | | 200 | 100 | | 400 | 500 | 600 | 800 | 1000 | 1200 |
| 1000 | 995 | 5 | 0 | 800 | 650 | 575 | 500 | 400 | 300 | 250 |
| 1100 | 1095 | 5 | 1 | 800 | 715 | 633 | 550 | 440 | 330 | 275 |
| 1200 | 1195 | 6 | 0 | 800 | 780 | 690 | 600 | 480 | 360 | 300 |
| 1300 | 1295 | 6 | 1 | 800 | 800 | 748 | 650 | 520 | 390 | 325 |
| 1400 | 1395 | 7 | 0 | 800 | 800 | 800 | 700 | 560 | 420 | 350 |
| 1500 | 1490 | 7 | 1 | 770 | 770 | 770 | 750 | 600 | 450 | 375 |
| 1600 | 1590 | 8 | 0 | 740 | 740 | 740 | 740 | 640 | 480 | 400 |
| 1700 | 1690 | 8 | 1 | 660 | 660 | 660 | 660 | 660 | 510 | 425 |
| 1800 | 1790 | 9 | 0 | 600 | 600 | 600 | 600 | 600 | 540 | 450 |
| 1900 | 1990 | 9 | 1 | 520 | 520 | 520 | 520 | 520 | 520 | 475 |
| 2000 | 1985 | 10 | 0 | 480 | 480 | 480 | 480 | 480 | 480 | 480 |
| 2100 | 2085 | 10 | 1 | 430 | 430 | 430 | 430 | 430 | 430 | 430 |
| 2200 | 2185 | 11 | 0 | 400 | 400 | 400 | 400 | 400 | 400 | 400 |
| 2300 | 2285 | 11 | 1 | 360 | 360 | 360 | 360 | 360 | 360 | 360 |
| 2400 | 2385 | 12 | 0 | 320 | 320 | 320 | 320 | 320 | 320 | 320 |
| 2500 | 2485 | 12 | 1 | 300 | 300 | 300 | 300 | 300 | 300 | 300 |

PORTATE PIANI LIGHT BI-BLOC CON TEGOLE 100 SPESSORE 0,6 - Load capacity Light Bi-Bloc shelves with tiles 100, thickness 0,6

| L. nom (mm) Nominal length (mm) | L. reale (mm) Length (mm) | Nr. Tegole N. of tiles | | Portata correnti Beams load capacity | Profondità spalla (mm) Upright frame depth (mm) | | | | | |
|--|---------------------------------|---------------------------|--|---|--|------------|------------|------------|------------|------------|
| | | 100 | | | 400 | 500 | 600 | 800 | 1000 | 1200 |
| 1000 | 995 | 10 | | 800 | 800 | 800 | 800 | 800 | 600 | 500 |
| 1100 | 1095 | 11 | | 800 | 800 | 800 | 800 | 800 | 660 | 550 |
| 1200 | 1195 | 12 | | 800 | 800 | 800 | 800 | 800 | 720 | 600 |
| 1300 | 1295 | 13 | | 800 | 800 | 800 | 800 | 800 | 780 | 650 |
| 1400 | 1395 | 14 | | 800 | 800 | 800 | 800 | 800 | 800 | 700 |
| 1500 | 1490 | 15 | | 770 | 770 | 770 | 770 | 770 | 770 | 750 |
| 1600 | 1590 | 16 | | 740 | 740 | 740 | 740 | 740 | 740 | 740 |
| 1700 | 1690 | 17 | | 660 | 660 | 660 | 660 | 660 | 660 | 660 |
| 1800 | 1790 | 18 | | 600 | 600 | 600 | 600 | 600 | 600 | 600 |
| 1900 | 1990 | 19 | | 520 | 520 | 520 | 520 | 520 | 520 | 520 |
| 2000 | 1985 | 20 | | 480 | 480 | 480 | 480 | 480 | 480 | 480 |
| 2100 | 2085 | 21 | | 430 | 430 | 430 | 430 | 430 | 430 | 430 |
| 2200 | 2185 | 22 | | 400 | 400 | 400 | 400 | 400 | 400 | 400 |
| 2300 | 2285 | 23 | | 360 | 360 | 360 | 360 | 360 | 360 | 360 |
| 2400 | 2385 | 24 | | 320 | 320 | 320 | 320 | 320 | 320 | 320 |
| 2500 | 2485 | 25 | | 300 | 300 | 300 | 300 | 300 | 300 | 300 |

Ripiani a pannelli

Panel shelves

Paneelböden

Planches à panneaux

Pasarela

TIRANTE DA MONTARE SUL CORRENTE CON I PANNELLI LIGHT BI-BLOC

Ties for fitting on beams with Light Bi-bloc panels

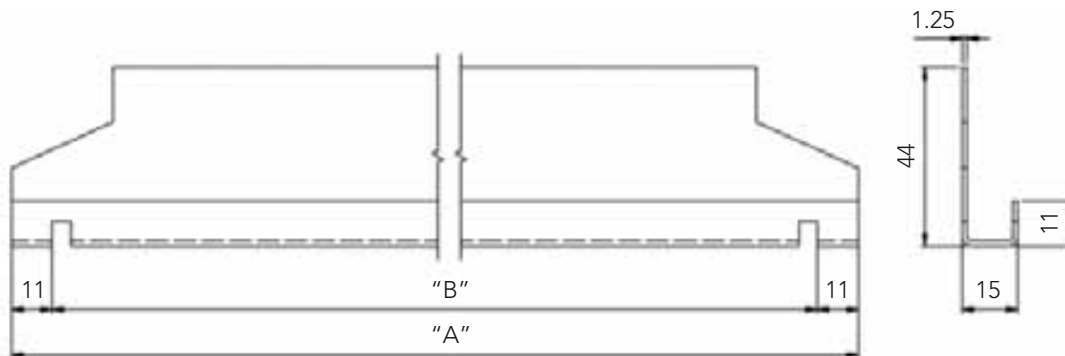

PORTATA PIANI DI CARICO PANNELLI LIGHT BI-BLOC

Load capacity of Light Bi-bloc panel shelves

PORTATE PIANI LIGHT BI-BLOC CON PANNELLI ERREX DA 100 SPESSORE 0,6 (CON TIRANTE ANTI TORSIONALE)

Load capacity Light Bi-Bloc shelves with Errex panels 100, thickness 0,6 (with anti-torsion tie)

| | | | | Portata pannelli (kg) Panels load capacity (kg) | | | | | |
|---------------------------------------|------------------------------|------------------------------|--|--|-----|-----|-----|------|------|
| | | | | 110 | 100 | 90 | 75 | 60 | 50 |
| L. nom (mm) Nominal length (mm) | L. reale (mm) Length (mm) | Nr. Pannelli N. of panels | Portata correnti Beams load capacity | Profondità spalla (mm) Upright frame depth (mm) | | | | | |
| | | | | 400 | 500 | 600 | 800 | 1000 | 1200 |
| 1000 | 1005 | 10 | 800 | 800 | 800 | 800 | 750 | 600 | 500 |
| 1100 | 1105 | 11 | 800 | 800 | 800 | 800 | 800 | 660 | 550 |
| 1200 | 1205 | 12 | 800 | 800 | 800 | 800 | 800 | 720 | 600 |
| 1300 | 1305 | 13 | 800 | 800 | 800 | 800 | 800 | 780 | 650 |
| 1400 | 1405 | 14 | 800 | 800 | 800 | 800 | 800 | 800 | 700 |
| 1500 | 1505 | 15 | 770 | 770 | 770 | 770 | 770 | 770 | 750 |
| 1600 | 1605 | 16 | 740 | 740 | 740 | 740 | 740 | 740 | 740 |
| 1700 | 1705 | 17 | 660 | 660 | 660 | 660 | 660 | 660 | 660 |
| 1800 | 1810 | 18 | 600 | 600 | 600 | 600 | 600 | 600 | 600 |
| 1900 | 1910 | 19 | 520 | 520 | 520 | 520 | 520 | 520 | 520 |
| 2000 | 2010 | 20 | 480 | 480 | 480 | 480 | 480 | 480 | 480 |
| 2100 | 2110 | 21 | 430 | 430 | 430 | 430 | 430 | 430 | 430 |
| 2200 | 2210 | 22 | 400 | 400 | 400 | 400 | 400 | 400 | 400 |
| 2300 | 2310 | 23 | 360 | 360 | 360 | 360 | 360 | 360 | 360 |
| 2400 | 2410 | 24 | 320 | 320 | 320 | 320 | 320 | 320 | 320 |
| 2500 | 2510 | 25 | 300 | 300 | 300 | 300 | 300 | 300 | 300 |

la gamma conveniente per la portata è evidenziata in giallo - the range offering the best load capacity is highlighted in yellow

PORTATE PIANI LIGHT BI-BLOC CON PANNELLI ERREX DA 200 SPESSORE 0,6 (CON TIRANTE ANTI TORSIONALE)

Load capacity Light Bi-Bloc shelves with Errex panels 200, thickness 0,6 (with anti-torsion tie)

| | | | | | Portata pannelli (kg) Panels load capacity (kg) | | | | | | |
|---------------------------------------|---------------------------------|------------------------------|-----|--|--|--|-----|-----|-------|------|------|
| | | | | | 110 | 100 | 90 | 75 | 60 | 50 | |
| L. nom (mm) Nominal length (mm) | L. reale (mm) Length (mm) | Nr. Pannelli N. of panels | | | Portata correnti Beams load capacity | Profondità spalla (mm) Upright frame depth (mm) | | | | | |
| | | 200 | 100 | | | 400 | 500 | 600 | 800 | 1000 | 1200 |
| 1000 | 1005 | 5 | 0 | | 800 | 550 | 500 | 450 | 375 | 300 | 250 |
| 1100 | 1105 | 5 | 1 | | 800 | 605 | 550 | 495 | 412,5 | 330 | 275 |
| 1200 | 1205 | 6 | 0 | | 800 | 660 | 600 | 540 | 450 | 360 | 300 |
| 1300 | 1305 | 6 | 1 | | 800 | 715 | 650 | 585 | 488 | 390 | 325 |
| 1400 | 1405 | 7 | 0 | | 800 | 770 | 700 | 630 | 525 | 420 | 350 |
| 1500 | 1505 | 7 | 1 | | 770 | 770 | 750 | 675 | 563 | 450 | 375 |
| 1600 | 1605 | 8 | 0 | | 740 | 740 | 740 | 720 | 600 | 480 | 400 |
| 1700 | 1705 | 8 | 1 | | 660 | 660 | 660 | 660 | 638 | 510 | 425 |
| 1800 | 1810 | 9 | 0 | | 600 | 600 | 600 | 600 | 600 | 540 | 450 |
| 1900 | 1910 | 9 | 1 | | 520 | 520 | 520 | 520 | 520 | 520 | 475 |
| 2000 | 2010 | 10 | 0 | | 480 | 480 | 480 | 480 | 480 | 480 | 480 |
| 2100 | 2110 | 10 | 1 | | 430 | 430 | 430 | 430 | 430 | 430 | 430 |
| 2200 | 2210 | 11 | 0 | | 400 | 400 | 400 | 400 | 400 | 400 | 400 |
| 2300 | 2310 | 11 | 1 | | 360 | 360 | 360 | 360 | 360 | 360 | 360 |
| 2400 | 2410 | 12 | 0 | | 320 | 320 | 320 | 320 | 320 | 320 | 320 |
| 2500 | 2510 | 12 | 1 | | 300 | 300 | 300 | 300 | 300 | 300 | 300 |

la gamma conveniente per la portata è evidenziata in giallo - the range offering the best load capacity is highlighted in yellow

PORTATE PIANI LIGHT BI-BLOC CON PANNELLI ERREX DA 300 SPESSORE 0,6 (CON TIRANTE ANTI TORSIONALE)

Load capacity Light Bi-Bloc shelves with Errex panels 300, thickness 0,6 (with anti-torsion tie)

| | | | | | | Portata pannelli (kg) Panels load capacity (kg) | | | | | |
|---------------------------------------|---------------------------------|------------------------------|-----|-----|---|--|-----|-----|-----|------|------|
| | | | | | | 110 | 100 | 90 | 75 | 60 | 50 |
| L. nom (mm) Nominal length (mm) | L. reale (mm) Length (mm) | Nr. Pannelli N. of panels | | | Portata correnti Beams load capacity | Profondità spalla (mm) Upright frame depth (mm) | | | | | |
| | | 300 | 200 | 100 | | 400 | 500 | 600 | 800 | 1000 | 1200 |
| 1000 | 1005 | 3 | 0 | 1 | 800 | 367 | 333 | 300 | 250 | 200 | 167 |
| 1100 | 1105 | 3 | 1 | 0 | 800 | 403 | 367 | 330 | 275 | 220 | 183 |
| 1200 | 1205 | 4 | 0 | 0 | 800 | 440 | 400 | 360 | 300 | 240 | 200 |
| 1300 | 1305 | 4 | 0 | 1 | 800 | 477 | 433 | 390 | 325 | 260 | 217 |
| 1400 | 1405 | 4 | 1 | 0 | 800 | 513 | 467 | 420 | 350 | 280 | 233 |
| 1500 | 1505 | 5 | 0 | 0 | 770 | 550 | 500 | 450 | 375 | 300 | 250 |
| 1600 | 1605 | 5 | 0 | 1 | 740 | 587 | 533 | 480 | 400 | 320 | 267 |
| 1700 | 1705 | 5 | 1 | 0 | 660 | 623 | 567 | 510 | 425 | 340 | 283 |
| 1800 | 1810 | 6 | 0 | 0 | 600 | 600 | 600 | 540 | 450 | 360 | 300 |
| 1900 | 1910 | 6 | 0 | 1 | 520 | 520 | 520 | 520 | 475 | 380 | 317 |
| 2000 | 2010 | 6 | 1 | 0 | 480 | 480 | 480 | 480 | 480 | 400 | 333 |
| 2100 | 2110 | 7 | 0 | 0 | 430 | 430 | 430 | 430 | 430 | 420 | 350 |
| 2200 | 2210 | 7 | 0 | 1 | 400 | 400 | 400 | 400 | 400 | 400 | 367 |
| 2300 | 2310 | 7 | 1 | 0 | 360 | 360 | 360 | 360 | 360 | 360 | 360 |
| 2400 | 2410 | 8 | 0 | 0 | 320 | 320 | 320 | 320 | 320 | 320 | 320 |
| 2500 | 2510 | 8 | 0 | 1 | 300 | 300 | 300 | 300 | 300 | 300 | 300 |

la gamma conveniente per la portata è evidenziata in giallo - the range offering the best load capacity is highlighted in yellow

